

Control Box Overview

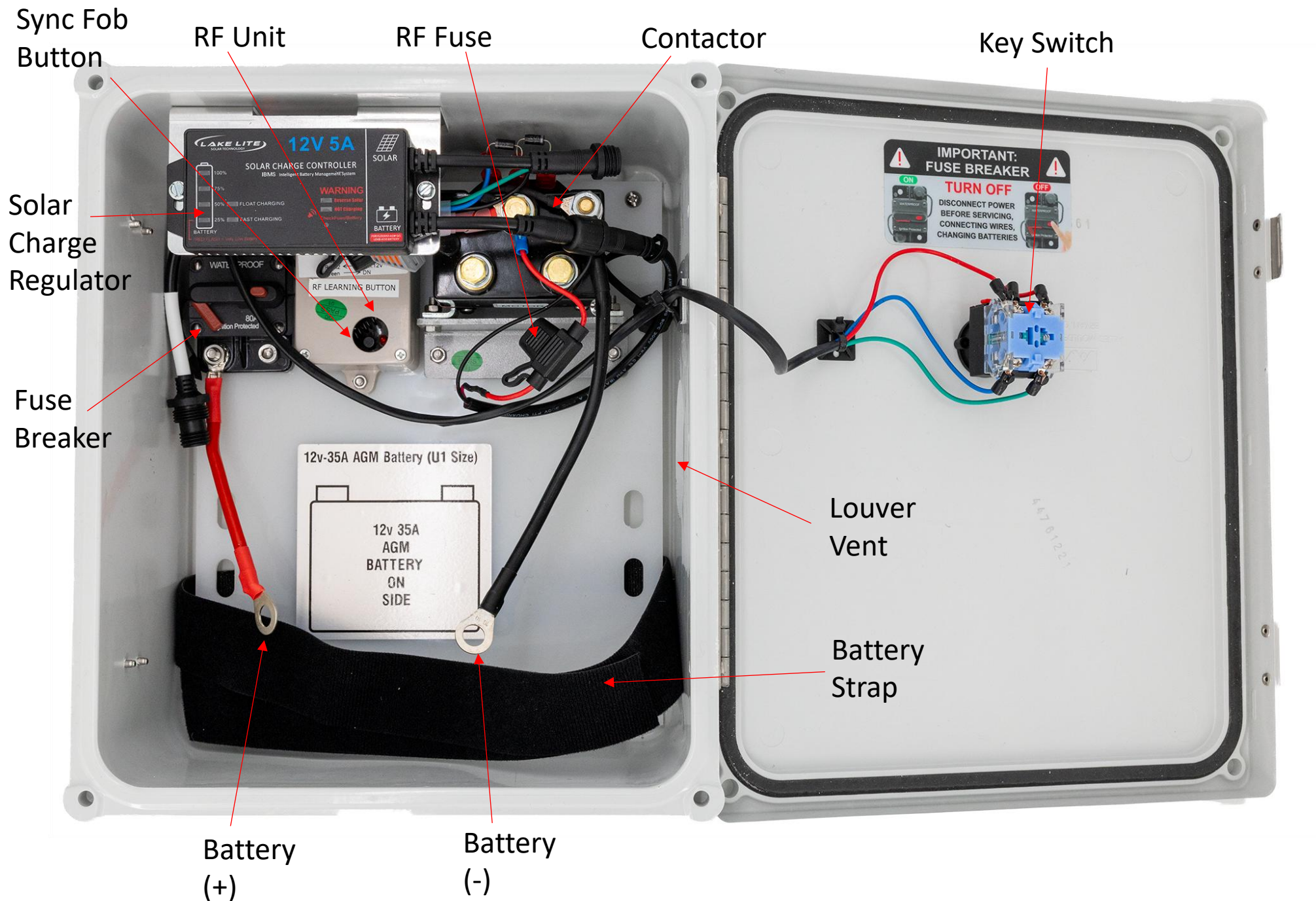

Battery & Regulator Connections

LAKE LIFTER: 100 Industrial Drive, Avilla IN 46710

Ph: 260-918-2758

Email: sales@lakelifter.com

LAKE LIFTER

DC POWERED BOAT LIFT MOTORS

1



Place 12v-35A (AGM) style battery into box.

2



Secure the solar charge regulator anywhere inside the box

3



Connect the power cables for both motor & solar charge regulator to the battery terminals

4



Feed the motor wires through the louver vent and connect them to the M1 and M2 studs

5



Connect the motor wires to the contactor studs labeled M1 & M2:

6

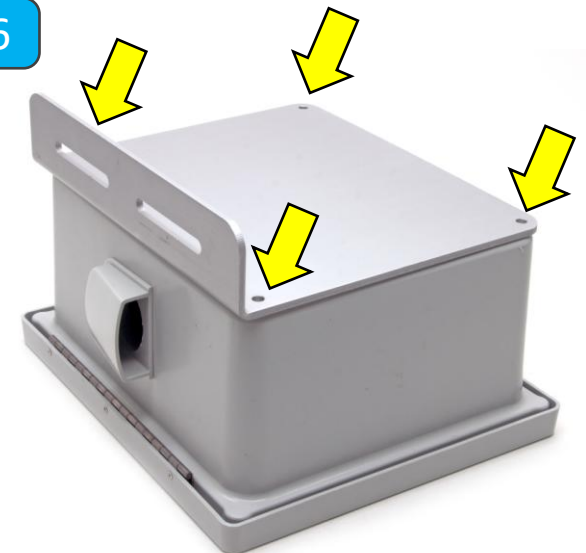

Mount the aluminum bracket to the back of the fiberglass box

Battery & Solar Mounted on Lift

7

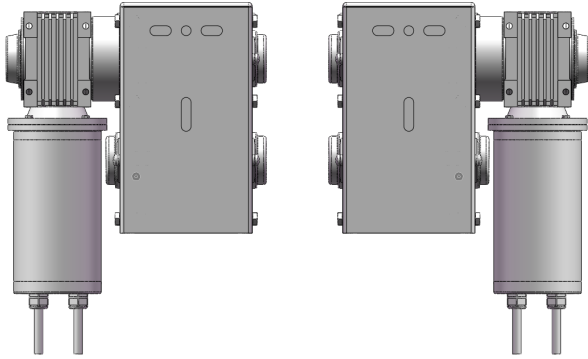

The Winch box is universal and can be mounted on either side of the lift.

8

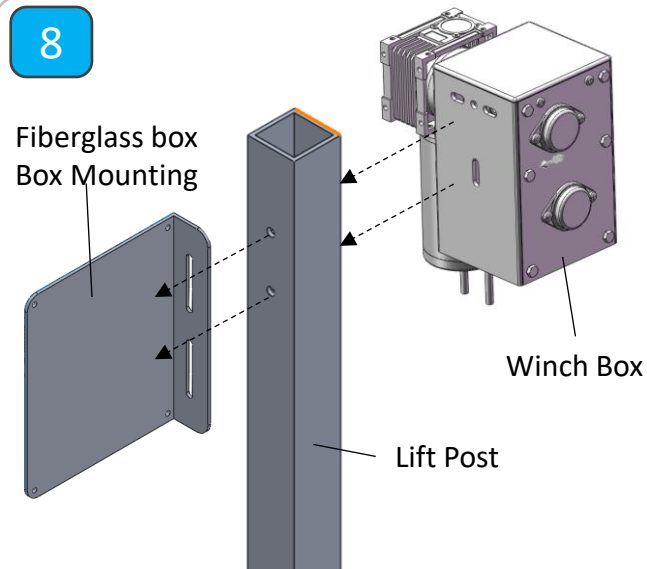

Use hardware to attach the winch box and fiberglass mount to the lift post as needed.

9

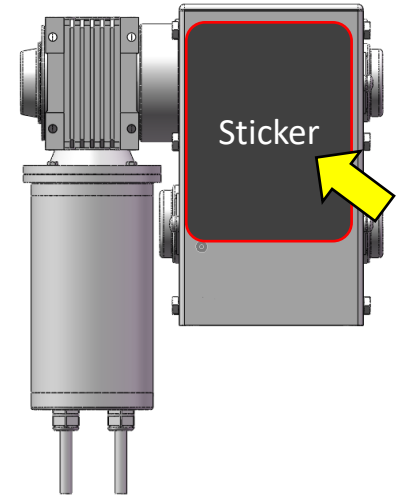

After mounting the winch to the lift, place the sticker over the exposed holes.



Example of finished installation on vertical lift



Example of finished installation on cantilever lift