

Solar Bumper Lite – For FLOE Dock Bumpers

LL-SDL-FLOE

40*
Lumens



[Solar Bumper Lights for FLOE Docks and Bumpers](#) are the latest in Solar Dock Light technology from Lake Lite Inc. Indirect downward lighting provides a unique, useful lighting effect on the dock surface for FLOE brand Dock Bumpers. The Solar Bumper Lights for Floe Docks and Bumpers are designed to fit FLOE Dock Brand Post covers or 3.5" OD post covers or post. Three bright LEDs positioned around the unit shine light downward and outward. The LED's illuminate the dock post as well as the dock surface providing indirect lighting. Solar Bumper Lights for FLOE Docks and Bumpers have a solar panel, which allows more power from the sun to ensure full charging resulting in all night light run times.

Available with Warm White, Amber or Blue LEDs

LIGHT CHARACTERISTICS

Light Source	3-Ultra-High intensity LED
Lumens output	40 Lumens *Varies with Color
Available LED Colors	Warm White, Amber or Blue LEDs
Light Mode Options	Constant
Visible Range	50m – 300m+ *Depending on Installation
Horizontal Output (degrees)	360° + Horizon
Vertical Divergence (degrees)	35-45°
LED Life Expectancy (hours)	> 100,000 hrs

ELECTRICAL CHARACTERISTICS

Circuit Protection	Integrated
Nominal Voltage (v)	1.2v
Autonomy (hours)	16-20hrs *On full Charge
Temperature Range	-4 to 158° Fahrenheit

SOLAR CHARACTERISTICS

Solar Module Type	Multicrystalline or Monocrystalline
Power (watts)	0.45 watts
Solar Module Efficiency (%)	16-17%

POWER SUPPLY

Battery Type	High Grade NiMh – ECO Friendly
Battery Size	1 AA
Battery Capacity (mAh)	1200 mAh
Nominal Voltage (v)	1.2v
Battery Service Life	1-3 years (Varies with local Environment)
Battery Service Access	Yes: User Changeable / Replaceable

PHYSICAL CHARACTERISTICS

Body Material	UV Stabilized ASA
Lens Material	UV Stabilized Poly Carbonate
External Lens Design	Integrate Convex Optics & Diffusion
Internal Lens design	360° Convex Optics & Diffusion
Waterproof Rating	IP 68
Mounting	Fits FLOE Vertical Bumper
Height	4-1/4"
Width / Diameter	5"
Weight	1.6 Lbs (2 pack)

OPTIONS

Custom Options, Sizes, & Colors	Please Contact
Custom Hardware & Mounting	Please Contact

* Information subject to change without notice



Lake Lite Inc.
100 Industrial Dr.
Avilla, IN 46710

Phone: 260-918-2758
E-mail: sales@lakelite.com
Web: www.lakelite.com

Solar Bumper Lite for FLOE Dock Bumpers

LL-SDL-FLOE-X

Installing Batteries & Cover

1. Install battery
2. Install silicone seal
3. Install battery cover
4. Insert T-Nut & Bolt
5. Push switch to ON
6. Guide T-Nut into Track
7. Tighten to Bumper Post.

Silicone Seal

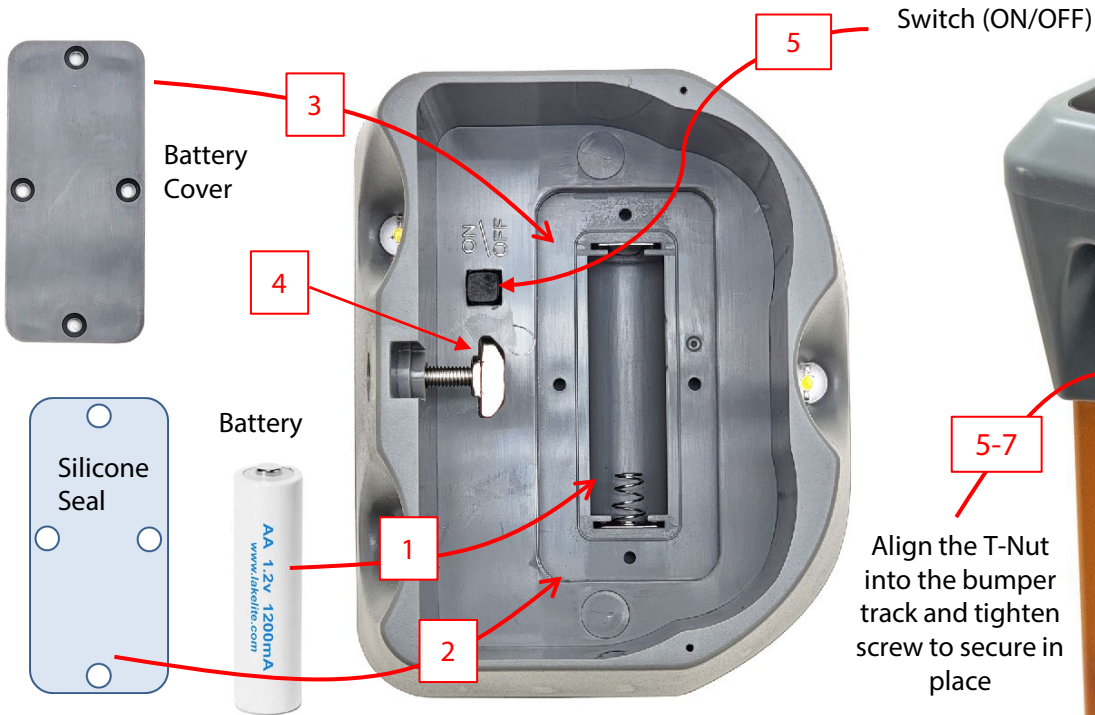

Storage Tips (Harsh Winters)



COLD winter weather can reduce battery life expectancy!

- Extreme cold weather can dramatically reduce the life expectancy of your rechargeable Ni-Cd or Ni-Mh batteries.
- Store your Solar Dock Light inside during cold months when your dock is not in use.

•For best results follow these tips:

1. **Charge batteries fully on a sunny day, before nightfall turn the switch to OFF.**
2. Store Lights with batteries inside in a warmer indoor climate for longer battery life. (Switched Off)
3. If the lights will be stored in a cold climate its recommended to remove the batteries from the lights and store the batteries in a warmer indoor climate.



CAUTION: PLEASE KEEP OUR ENVIRONMENT CLEAN! BATTERIES MUST BE RECYCLED OR DISPOSED OF PROPERLY.



Lake Lite Inc.
100 Industrial Dr.
Avilla, IN 46710

Phone: 260-918-2758
E-mail: sales@lakelite.com
Web: www.lakelite.com